

CLASSIC STEEL

Installation Instruction of Fire Steel Door with Expansion-Shell Anchor

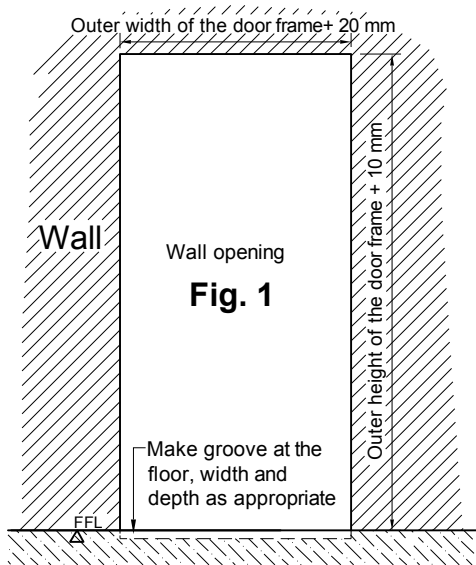

1. Prepare wall opening for installation of fire steel door to get size as follows :
 - Width = Outer width of the door frame + 20 mm.
 - Height = Outer height of the door frame (height from FFL to top of the door frame) + 10 mm.
 - Make groove at the floor, width and depth as appropriate (for embedding of bottom channel or threshold/bottom frame) As shown on Fig. 1

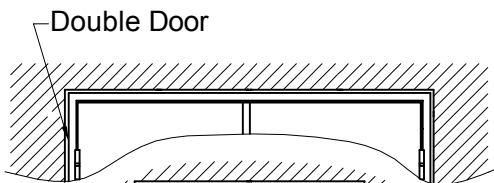

2. Bring whole set of the door to put into the wall opening. Close the door leaf and adjust level of bottom edge of the door leaf to proper level as requirements by supporting beneath the bottom edge of the door frame with some pieces of carton box of the door. Adjust the door leaf and door frame to get plane with the wall and the gap between the door leaf and the door frame to be consistent all around. As shown on Fig. 2

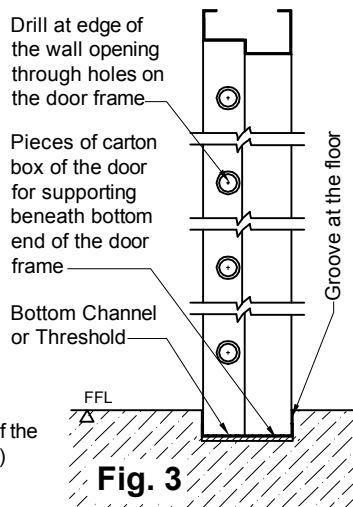
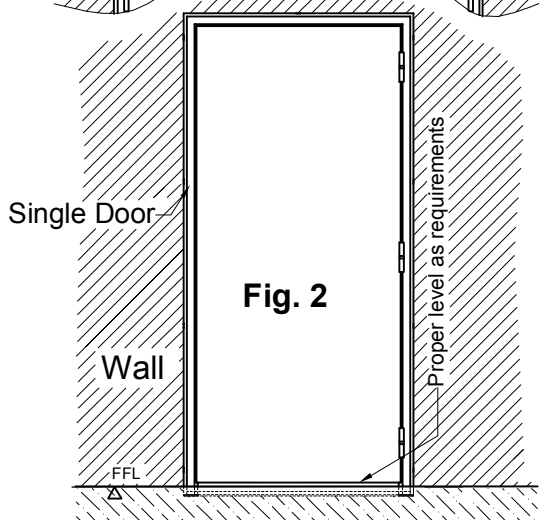

3. Open the door leaf in order to drill at edge of the wall opening through anchor holes on the door frame at only top and bottom holes at hinge side of the door frame first. Then embed expansion-shell anchors through the anchor holes on the door frame into edge of the wall opening. Insert u-washers to fill the gap between edge of the wall opening and the door frame. Then turn the bolts by block wrench through the anchor holes on the door frame until completely tight to fix this side of the door frame first.

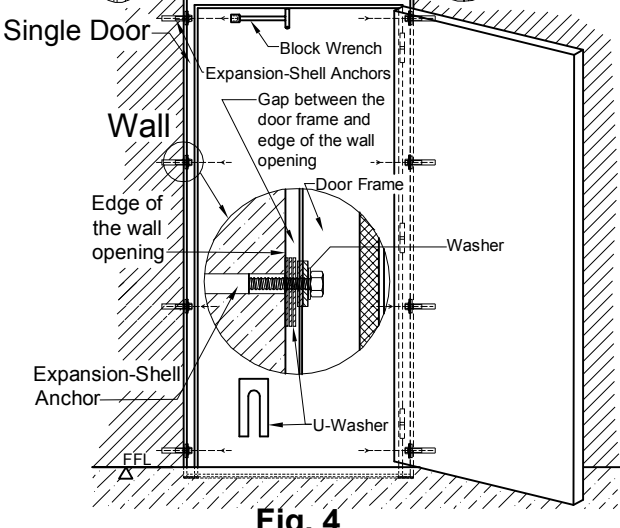
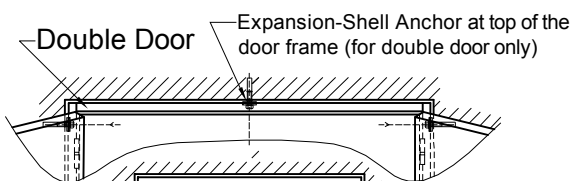

4. Close the door leaf to check and adjust position of the door frame and the door leaf to get plan with the wall as well as the gap between the door frame and the door leaf to be consistent all around. Hold the door frame at the lock side (for single door), or the other hinge side (for double door) firmly. Then open the door leaf in order to drill and embed the anchors through the holes on the door frame into edge of the wall opening at only top and bottom holes at lock side (for single door), or the other hinge side (for double door), same as the first two holes done at hinge side of the door frame.

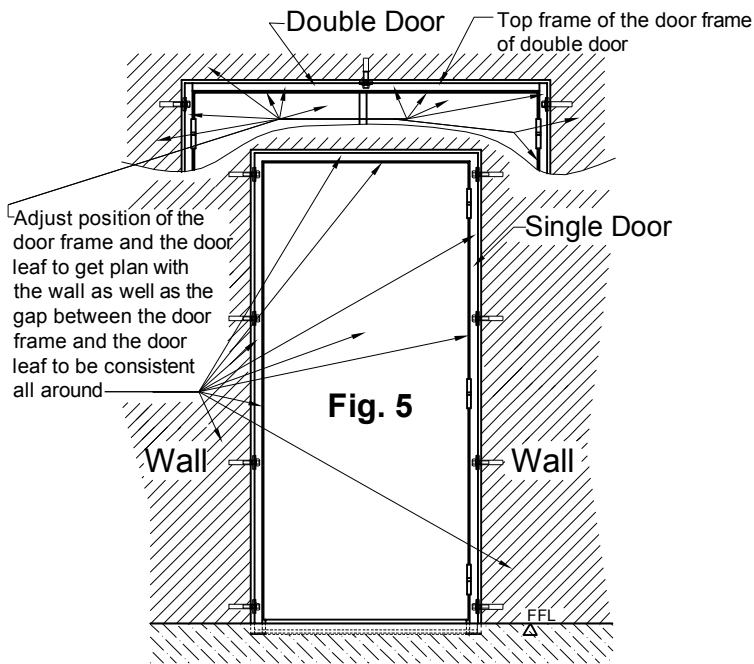

5. Insert u-washers and turn the bolts but not completely tight yet. Then close the door leaf again to check and adjust position of the door frame and door leaf to get plan with the wall as well as the gap between the door frame and the door leaf to be consistent all around.

Open the door leaf to turn both bolts that were turned not completely tight yet until completely tight. Then drill and embed the other anchors through the other holes on the door frame. Insert u-washer and turn the bolts until completely tight (the expansion-shell anchors, u-washers have been provided together with the door)

As shown on Fig. 3, Fig. 4 and Fig. 5

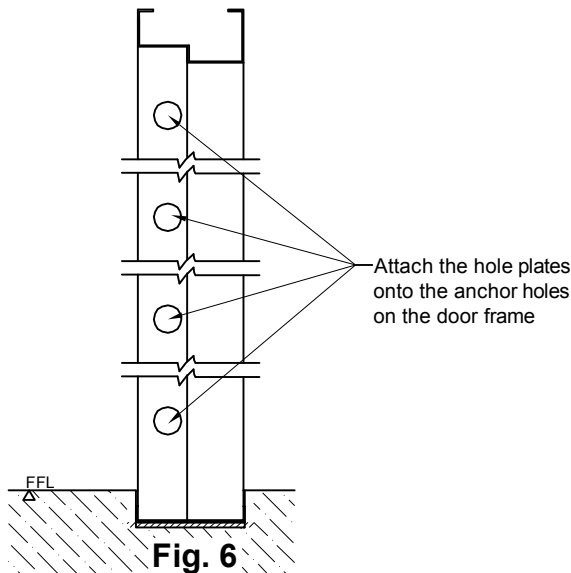

6. Attach the hole plates onto the anchors holes on the door frame and firmly press until completely flush on the door frame surface. (the hole plates have been provided together with the door).

As shown on Fig. 6

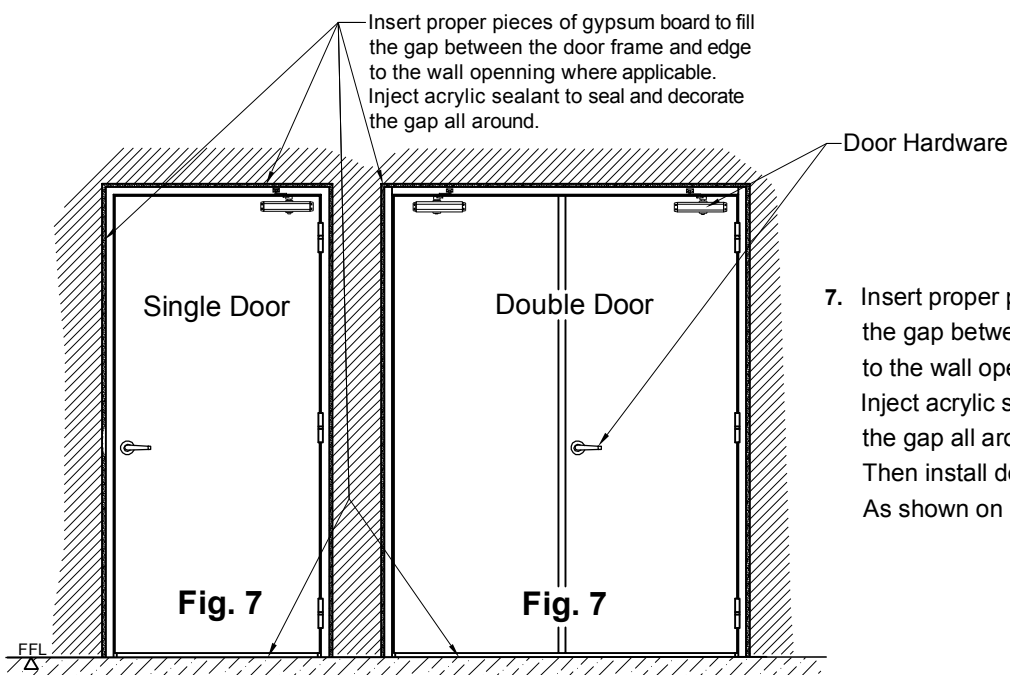

7. Insert proper pieces of gypsum board to fill the gap between the door frame and edge to the wall opening where applicable. Inject acrylic sealant to seal and decorate the gap all around.

Then install door hardware as requirements. As shown on Fig. 7